

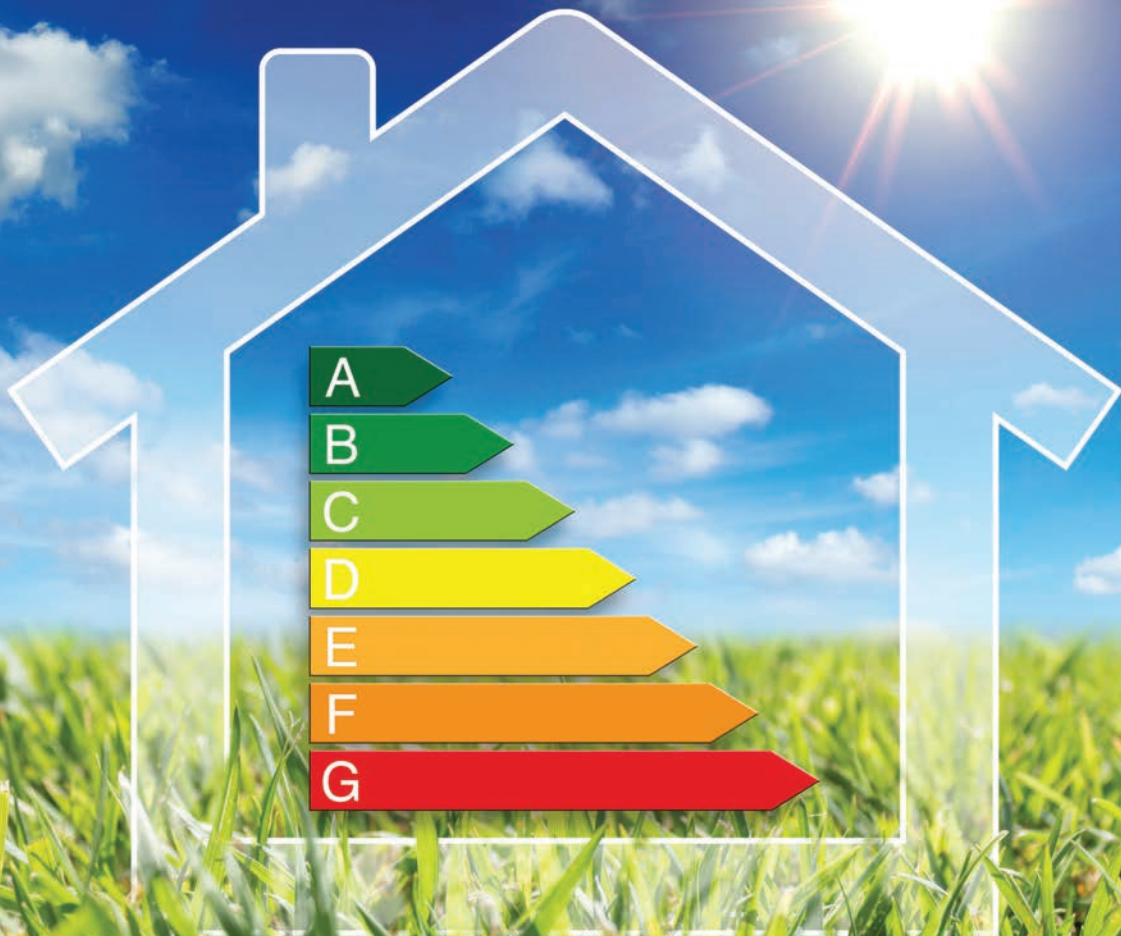

# Warmline PIR

PIR Bonded to Plasterboard

The Warmline insulating laminates are designed as a simple effective way to improve the thermal efficiency in both walls and roof applications. They are fully applicable with Part L of the building regulations.



**U Value**

Insulation and  
Drywall Products



## Polyisocyanurate Foam Bonded to Plasterboard Benefits

- All thicknesses readily available
- Simple solution to upgrading walls and roofs
- Quick and easy to install
- Can be used for both newbuild and refurb
- A simple way to meet building regulations
- Cost effective return

## Technical Specifications

Product Code & Size	Description	Overall Thickness	Foam Thickness	Plasterboard Thickness	Sheets per Pallet	m <sup>2</sup> per Board	Thermal Resistance R-value	U-value Fixed Batons (W/m <sup>2</sup> K)	U-value Dot & Dab (W/m <sup>2</sup> K)
Warmline PIR 1.2 x 2.4	PIR Bonded to Plasterboard	27mm	17mm	9.5mm	78	2.88	0.840	0.679	0.709
		29mm	17mm	12.5mm	74	2.88	0.855	0.672	0.701
		35mm	25mm	9.5mm	60	2.88	1.181	0.551	0.571
		38mm	25mm	12.5mm	55	2.88	1.196	0.547	0.566
		48mm	38mm	9.5mm	44	2.88	1.772	0.416	0.427
		50mm	38mm	12.5mm	42	2.88	1.787	0.413	0.424
		60mm	50mm	9.5mm	35	2.88	2.318	0.339	0.346
		62.5mm	50mm	12.5mm	34	2.88	2.333	0.337	0.344
		70mm	60mm	9.5mm	30	2.88	2.772	0.294	0.299
		72.5mm	60mm	12.5mm	29	2.88	2.787	0.292	0.298
		80mm	70mm	9.5mm	26	2.88	3.227	0.259	0.263
		82.5mm	70mm	12.5mm	25	2.88	3.242	0.258	0.262
		90mm	80mm	9.5mm	23	2.88	3.681	0.232	0.235
		92.5mm	80mm	12.5mm	22	2.88	3.696	0.231	0.234
102mm	90mm	12.5mm	21	2.88	4.152	0.209	0.212		

Calculations are based on a 215mm thick solid brickwork wall and includes a 2mm plaster skim coat. Timber battens are 25x50mm at 600mm Centres

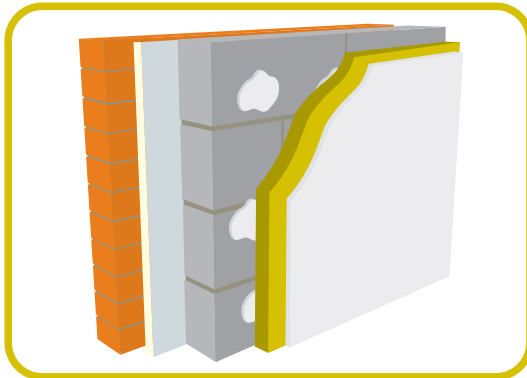

### Fixing instructions for Dot and dab

- For bonding Warmline range to a wall use a proprietary gypsum based adhesive.
- Please follow the manufacturers instructions. As per manufacturers recommendations apply a continuous ribbon of adhesive around any openings.
- Apply 3 vertical rows of adhesive dabs to the walls at 300mm centres. Also insure that there is a continuous bead at the bottom and top.
- After the adhesive has set fix a minimum of 2 insulation anchors through the board into the wall. They must go into the masonry by a minimum of 30mm.

### Fixing instructions for mechanical fixing

- Fix to the wall treated batons 50mm x 25mm at a maximum of 600mm centres. Also fit horizontal batons at both floor and ceiling level.
- Then fit the warmline board using drywall screws at 150mm centres. Always insure that they penetrate the batons by 25mm.
- When installing boards to rafters fix them at right angles to the timbers. To ensure a solid finish bridging pieces are to used inbetween the rafters.

